



HANGING ART
2016





HANGING ART

Mbs Hanging Systems was established in 2014 to offer innovative, museum quality, professional art hanging services and supplies through advanced art hanging hardware. Mbs Hanging Systems' amazing product line was born from innovations that began with our sister company, Mbs Standoffs, which has offered state-of-the-art signage hardware for over 15 years. We saw the need for high-quality art hanging hardware at affordable prices and we took up the challenge.

Our dedicated design team, in partnership with galleries, museums, and businesses around the world, worked diligently to create a simple, beautiful, and flexible product line that is as amazing to use as it is to look at.

All of our products share one thing in common – they were designed with your needs in mind. Installation is straightforward and simple to save you time and stress. Flexibility is at an all-time high – move your art up, down, or side-to-side until it's just right. Adding, removing, or changing your art is easier than ever – it takes only a few seconds and best of all, no tools required.

At Mbs Hanging Systems, we believe the tools we provide should work so well that you don't have to consider how they might have been designed differently. That's why we strive to provide the highest quality professional art hanging products at the best price – every time.



Easy Rail System

Our Easy Rail System is simple and discreet, designed use in the home, office, or anywhere that appearance is important.

The key to this beautiful and strong system, rated to withstand loads up to 78 lbs (35 kg), is a series of high strength clips that install behind the rail and out of view.

Thanks to the modular nature of the Easy Rail System, you can add to, remove from, or modify your display at any time in just seconds – and no more holes in the wall!



Classic Rail System

Our Classic Rail System is effortless and inconspicuously designed, with a focus on strength, rated to hold up to an amazing 300 lbs (136 kg) per rail!

The Classic Rail System is designed with galleries in mind, where a display may be changed many times per week.

All of our Hanging Cables and Rods hook on and off in one simple motion to make it easier than ever for you to quickly update your displays!



Ceiling Rail

Our Ceiling Rail System installs into the ceiling instead of the traditional wall mounted application.

Mount it open-faced to make changing your display easier than ever or turn it around for a closed-face installation that makes your Art Hanging System even more subtle than before.

Use it in the window of your shop or use it a few inches off of the wall to give your art an amazing floating effect!





CONTENTS

Easy Rail	3
Classic Rail	9
Ceiling Rail	15
Items list	21
Ball End	22
Cobra	22
“p”	23
Self-Gripping	24
Screw Gripping	26
Looper for Nylon Cable	26
Cable Tensioner	26
Spring Gripping	27
Picture Stabilizer	27
Hardware	27
Cable Systems	29
Sign Holders	31
Cable Kits	38
Rod Kits	48



EASY RAIL

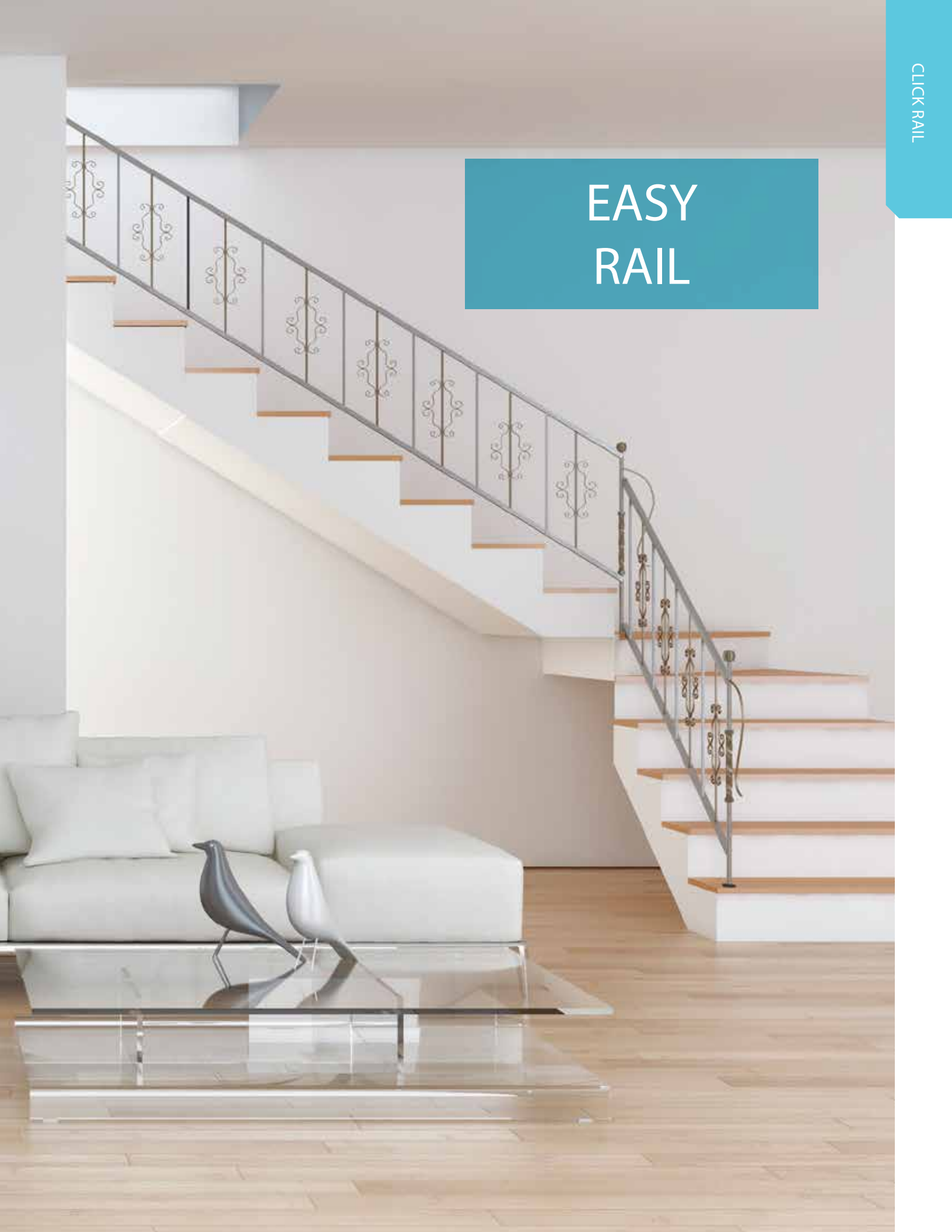



Easy Rails are Picture Hanging Systems that are optimized for home or office usage. In order to put your system together you will need to choose your finish options, then your hanging options and finally your hook options. Once you have the core of your system selected, you can pick accessories or installation hardware from our offering.

1 Finishes



Silver Satin Anodized



Black Satin Anodized



White Painted



180 Colors
Powder Coated

2 Hanging Option

Ball End Cable
Available in
Stainless Steel



Cobra
Available in Stainless
Steel and Nylon



3 Hook Option

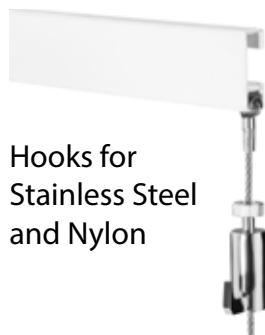

Hooks for
Stainless Steel
and Nylon



Hooks for
Nylon

EASY RAIL

Wall-Mounted



AT100-A	Silver Satin Anodized
AT100-B	Black Satin Anodized
AT100-W	White Painted
AT100-C	180 Colors Finishes*
AT100-MF	Natural Milled**

* RAL standard colors with fee

** Can have manufacturing scratches

Modern Design and Discreet! Easy to install!

The Easy Rail is secured to the wall using fastening clips that conceal all fittings and wall anchors

Simply affix the supplied fastening clips to the wall and snap Easy Rail to the clips.

The Easy Rail picture hanging system is compatible with a wide variety of our hangers and hooks that make adjustment both horizontally and vertically easy, effortless and without damage to walls. Nails and unwanted holes will be a thing of the past when using Easy Rail.

Application: Wall-Mounted

Material: Aluminum

Available Length: (72") - (182.88 cm)

Rail Height: 25 mm - (1")

Available Colors: Silver Satin Anodized, Black Satin Anodized, White Painted & 180 Colors Powder Coated

Rated Rail Weight: 75 lb / 35 kg (When Properly Installed)

Installation

The Easy Rail mounts to the walls with the use of Screws and Anchors.

1. To hang items using the Click Rail, you must select your hanger preference
 - Cobra Cable
 - Ball-End Cable
2. After you have selected your hanger option you must then select your hook preference
 - Cable Hook for Stainless Steel and Nylon Cable
 - Spring Hook for Nylon Cable

Hanger Compatibility

1. Cobra Cable – Nylon / 13 lbs
2. Cobra Cable – Stainless Steel / 26 lbs
3. Ball-End Cable Stainless Steel / 45 lbs



EASY RAIL

Wall-Mounted

AT100-A	Silver Satin Anodized
AT100-B	Black Satin Anodized
AT100-W	White Painted
AT100-C	180 Colors Choice*
AT100-MF	Natural Milled**

* RAL standard colors

** Can have manufacturing scratches



Choose Your Finish



Installation Instructions



1. Mark your installation location and install 6 Locators, each 12 inches apart. If you use multiple rails end-to-end, use a Connector to install them flush.



2. After your hardware is installed on the wall, line up the top of the rail with the top of the Locators, then push the bottom down until it Easys into place.

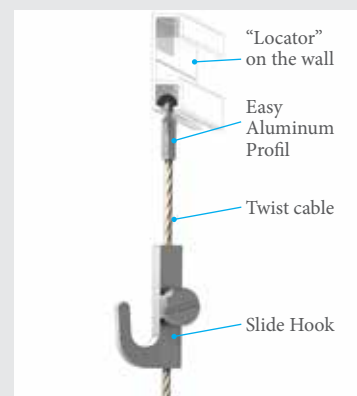

3. Finally, attach your cable to the rail and your hook to the cable and you have a beautiful picture hanging system ready to go!

EASY RAIL

Wall-Mounted

Compatible with

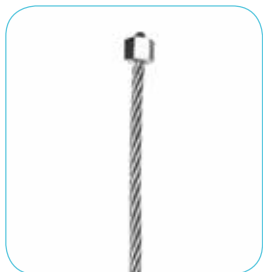

Stainless Steel
Ball End Cable



Stainless Steel
Cobra Cable



Nylon
Cobra Cable



Nylon
Cobra Cable



H104
PG 24



SGH100
PG 24



H100
PG 26



SH100
PG 27



H105
PG 24

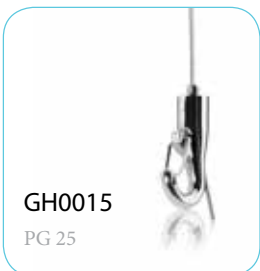

GH0015
PG 25



H101
PG 26



H103
PG 24



GH0014
PG 25



GH0013
PG 25



GH0012
PG 25



CLASSIC RAIL

CLASSIC RAIL





Classic Rails are Picture Hanging Systems that are optimized for galleries, museums, etc. In order to put your system together you will need to choose your finish options, then your hanging options and finally your hook options. Once you have the core of your system selected, you can pick accessories or installation hardware from our offer.

1 Finishes



White
Painted



Silver Satin
Anodized



Black Satin
Anodized



180 Colors
Powder Coated

2 Hanging Option



'J' Hook
Rod



'P' Hook
Rod



'P' Hook
cable

Available in Stainless Steel and Nylon

3 Hook Option

Hooks for Stainless
Steel and Nylon



Hooks for Nylon



CLASSIC RAIL

Wall-Mounted



AT101-A	Silver Satin Anodized
AT101-B	Black Satin Anodized
AT101-W	White Painted
AT101-C	180 Colors Finishes*
AT101-MF	Natural Milled**

* RAL standard colors with fee

** Can have manufacturing scratches

The Classic Rail picture hanging is compatible with a wide variety of our hangers and hooks that make adjustment both horizontal and vertically easy, effortless and without damage to walls. Nails and unwanted holes will be a thing of the past when using Easy Rail.

Installation

The Classic Rail mounts to the walls with the use of Screws and Anchors.

1. To hang items using the Classic Rail, you must select your hanger preference
 - Cable "P"
 - Rod "P"
 - Rod "J"
2. After you have selected your hanger option you must then select your hook preference
 - Cable Hook for Stainless Steel and Nylon Cable
 - Spring Hook for Nylon Cable

Application: Wall-Mounted

Material: Aluminum

Available Length: (72") - (182.88 cm)

Rail Height: 25 mm - (1")

Available Colors: Silver Satin Anodized, Black Satin Anodized, White Painted & 180 Colors Powder Coated

Rated Rail Weight: 75 lb / 35 kg (When Properly Installed)

Hanger Compatibility

1. Cobra Cable - Nylon / 13 lbs
2. Cobra Cable - Stainless Steel / 26 lbs
3. Ball-End Cable Stainless Steel / 45 lbs



CLASSIC RAIL

Wall-Mounted

AT101-A	Silver Satin Anodized
AT101-B	Black Satin Anodized
AT101-W	White Painted
AT101-C	180 Colors Choice*
AT101-MF	Natural Milled**

* RAL standard colors

** Can have manufacturing scratches



Choose Your Finish



Installation Instructions

Classic Rail, Picture Hanging mounts to the wall with the use of (8) No. 6 Screws and Anchors.

Note: This rail comes with 8 Pre-drilled holes.



CLASSIC RAIL

Wall-Mounted

Compatible with



"P" Hook
with Stainless Steel
Cable



"P" Hook
with Nylon Cable



"P" Hook
with Nylon Cable



H104
PG 24

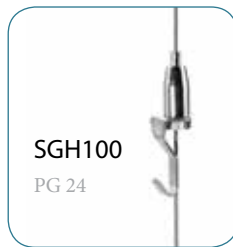

SGH100
PG 24



H100
PG 26



SH100
PG 27



H105
PG 24

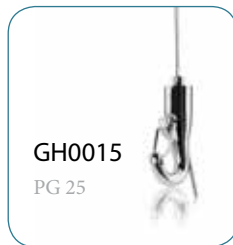

GH0015
PG 25



H101
PG 26



H103
PG 24

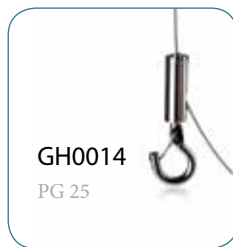

GH0014
PG 25



GH0013
PG 25

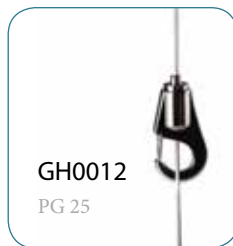

GH0012
PG 25



CEILING RAIL





Ceiling Rails are Picture Hanging Systems that are optimized for home or office usage. In order to put your system together you will need to choose your finish options, then your hanging options and finally your hook options. Once you have the core of your system selected, you can pick accessories or installation hardware from our offering.

1 Finishes



White
Painted



Silver Satin
Anodized



Black Satin
Anodized



180 Colors
Powder Coated

2 Hanging Option



'J' Hook
Rod



'P' Hook
Rod



'P' Hook
cable

Available in Stainless Steel and Nylon

3 Hook Option

Hooks for Stainless
Steel and Nylon



Hooks for Nylon



CEILING RAIL

Ceiling Mount



AT102-A	Silver Satin Anodized
AT102-B	Black Satin Anodized
AT102-W	White Painted
AT102-C	180 Colors Finishes*
AT102-MF	Natural Milled**

* RAL standard colors with fee

** Can have manufacturing scratches

The Ceiling Rail picture hanging is compatible with a wide variety of our hangers and hooks that make adjustment both horizontal and vertically easy, effortless and without damage to walls. Nails and unwanted holes will be a thing of the past when using Ceiling Rail.

Installation

The Ceiling Rail mounts to the walls with the use of Screws and Anchors.

1. To hang items using the Ceiling Rail, you must select your hanger preference
 - Cable "J"
 - Cable "P"
2. After you have selected your hanger option you must then select your hook preference
 - Cable Hook for Stainless Steel and Nylon Cable
 - Spring Hook for Nylon Cable

Application: Wall-Mounted

Material: Aluminum

Available Length: (72") - (182.88 cm)

Rail Height: 25 mm - (1")

Available Colors: Silver Satin Anodized, Black Satin Anodized, White Painted & 180 Colors Powder Coated

Rated Rail Weight: 75 lb / 35 kg (When Properly Installed)

Hanger Compatibility

1. Cobra Cable - Nylon / 13 lbs
2. Cobra Cable - Stainless Steel / 26 lbs
3. Ball-End Cable Stainless Steel / 45 lbs



CEILING RAIL

Ceiling Mount

AT102-A	Silver Satin Anodized
AT102-B	Black Satin Anodized
AT102-W	White Painted
AT102-C	180 Colors Finishes*
AT102-MF	Natural Milled**

* RAL standard colors with fee

** Can have manufacturing scratches



Choose Your Finish



Installation Instructions

Ceiling Rails, Picture Hanging Systems mounts to the wall with the use of (8) No. 6 Screws and Anchors.

Note: This rail comes with 8 Pre-drilled holes.



CEILING RAIL

Ceiling Mount

Compatible with



"J" & "P" Hook
with Stainless Steel
Cable



"J" & "P" Hook
with Nylon Cable



"J" & "P" Hook
with Nylon Cable



H104
PG 24

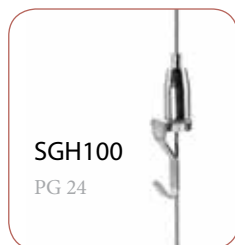

SGH100
PG 24



H100
PG26



SH100
PG 27



H105
PG 24

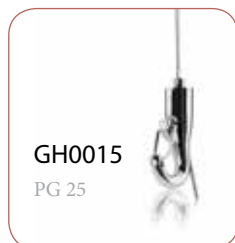

GH0015
PG 25



H101
PG 26



H103
PG 24

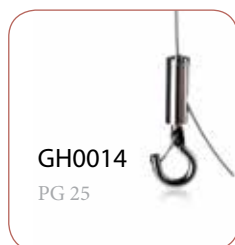

GH0014
PG 25



GH0013
PG 25

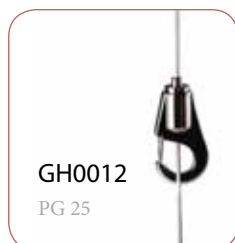

GH0012
PG 25



ITEMS LIST

BALL END

Stainless Steel

Diameter: 1/16"

Rated Strength: 45 Lbs (20 Kg)

For: Easy Rail

Length	Item #
48"	SSC101-48
72"	SSC101-72
96"	SSC101-96
120"	SSC101-120



COBRA

Stainless Steel

Diameter: 1/16"

Rated Strength: 45 Lbs (20 Kg)

For: Easy Rail

Length	Item #
48"	SSC100-48
72"	SSC100-72
96"	SSC100-96
120"	SSC100-120

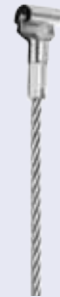

COBRA

Nylon

Diameter: 1/16"

Rated Strength: 15 Lbs (6 Kg)

For: Easy Rail

Length	Item #
48"	NC100-48
72"	NC100-72
96"	NC100-96
120"	NC100-120



"P"

Stainless Steel

Diameter: 1/16"

Rated Strength: 45 Lbs (20 Kg)

For: Classic Rail, Ceiling Rail

Length	Item #
48"	SSC104-48
72"	SSC104-72
96"	SSC104-96
120"	SSC104-120

**"P"**

Nylon

Diameter: 1/16"

Rated Strength: 15 Lbs (6 Kg)

For: Classic Rail, Ceiling Rail

Length	Item #
48"	NC104-48
72"	NC104-72
96"	NC104-96
120"	NC104-120

**"J"**

Aluminum

Square: 3/16"

Rated Strength: 70 Lbs (31 Kg)

For: Classic Rail, Ceiling Rail

Lenght	White Finish	Black Anodized Finish	Clear Anodized Finish	180 Color Finishes*
48"	SSC104-48-W	SSC104-48-B	SSC104-48-A	SSC104-48-C
72"	SSC104-72-W	SSC104-72-B	SSC104-72-A	SSC104-72-C
96"	SSC104-96 -W	SSC104-96-B	SSC104-96-A	SSC104-96-C

*Fee must be applied

**"J"**

Aluminum

Square: 3/16"

Rated Strength: 70 Lbs (31 Kg)

For: Classic Rail, Ceiling Rail

Lenght	White Finish	Black Anodized Finish	Clear Anodized Finish	180 Color Finishes*
48"	NC104-48-W	NC104-48-B	NC104-48-A	NC104-48-C
72"	NC104-72-W	NC104-72-B	NC104-72-A	NC104-72-C
96"	NC104-96 -W	NC104-96-B	NC104-96-A	NC104-96-C

*Fee must be applied



Brass

For: Classic Rail, Ceiling Rail



Brass

For: Classic Rail, Ceiling Rail

Technical drawing of the 'A' section of a mechanical assembly. The drawing shows a cross-section of a vertical shaft with a flange at the top and a base. The shaft has a diameter of 12mm and a length of 38.4mm. The flange has a diameter of 15.16mm and a thickness of 4mm. The base has a diameter of 12mm and a height of 6.3mm. The shaft is threaded with M4 threads at the top and bottom. The top thread has a pitch of 3/16 inch and a diameter of 4mm. The bottom thread has a pitch of 1/16 inch and a diameter of 2mm. The shaft is shown in section A-A, with the section line passing through the center. The drawing is labeled 'SECTION A-A' and 'SCALE 3:1'.



Zinc

For: Classic Rail, Ceiling Rail



Brass

For: Classic Rail, Ceiling Rail



SELF-GRIPPING

Brass

Finish: Nickel Plating

For use with: Ball End, Cobra Cable, "J" Hook Cable, "P" Hook Cable

For Cable Diameter: $\frac{3}{64}$ " (1.2 mm) to $\frac{1}{16}$ " (1.5 mm)

Rated Strength: 15 Lbs (6 Kg)

For: Classic Rail, Ceiling Rail

Item#: GH0012

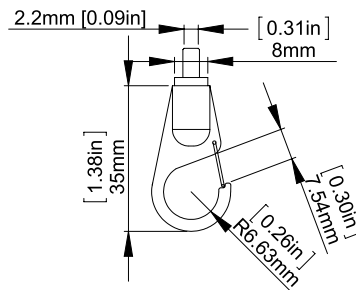

SELF-GRIPPING

Brass

Finish: Nickel Plating

For use with: Ball End, Cobra Cable, "J" Hook Cable, "P" Hook Cable

For Cable Diameter: $\frac{3}{64}$ " (1.2 mm) to $\frac{1}{16}$ " (1.5 mm)

Rated Strength: 15 Lbs (6 Kg)

For: Classic Rail, Ceiling Rail

Item#: GH0013

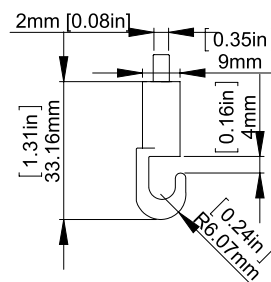

SELF-GRIPPING

Brass

Finish: Nickel Plating

For use with: Ball End, Cobra Cable, "J" Hook Cable, "P" Hook Cable

For Cable Diameter: $\frac{3}{64}$ " (1.2 mm) to $\frac{1}{16}$ " (1.5 mm)

Rated Strength: 15 Lbs (6 Kg)

For: Classic Rail, Ceiling Rail

Item#: GH0014

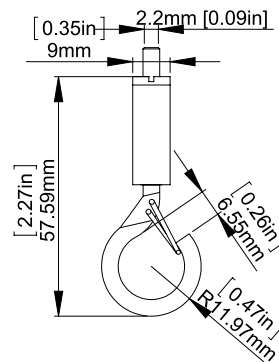

SELF-GRIPPING

Brass

Finish: Nickel Plating

For use with: Ball End, Cobra Cable, "J" Hook Cable, "P" Hook Cable

For Cable Diameter: $\frac{3}{64}$ " (1.2 mm) to $\frac{1}{16}$ " (1.5 mm)

Rated Strength: 15 Lbs (6 Kg)

For: Classic Rail, Ceiling Rail

Item#: GH0015

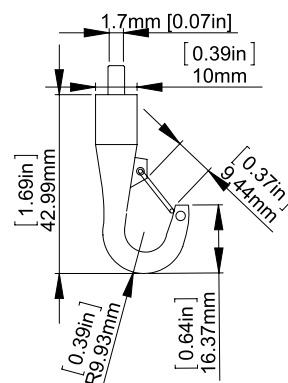

SCREW GRIPPING

Brass

Finish: Nickel Plating

For use with: Ball End, Cobra Cable, "J" Hook Cable, "P" Hook Cable

For Cable Diameter: $\frac{3}{64}$ " (1.2 mm) to $\frac{1}{16}$ " (1.5 mm)

Rated Strength: 15 Lbs (6 Kg)

For: Classic Rail, Ceiling Rail

Item#: H100

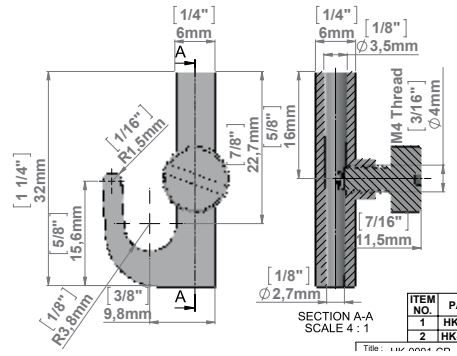

SCREW GRIPPING

Aluminum

Finish: Nickel Plating

For use with: Ball End, Cobra Cable, "J" Hook Cable, "P" Hook Cable

For Cable Diameter: $\frac{3}{64}$ " (1.2 mm) to $\frac{1}{16}$ " (1.5 mm)

Rated Strength: 15 Lbs (6 Kg)

For: Classic Rail, Ceiling Rail

Item#: H101

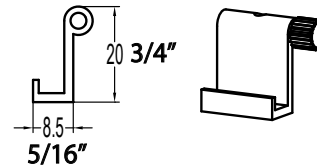

LOOPER FOR STAINLESS STEEL AND NYLON CABLE

Locking Loop — Aluminum

Finish: Clear Anodized

For Cable Diameter: $\frac{1}{16}$ " (2 mm)

Rated Strength: 15 Lbs (6 Kg)

Item#: DG005

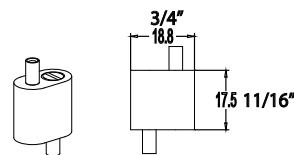

CABLE TENSIONER

Spring

Application: Cable Tensioner

Item#: TSS100

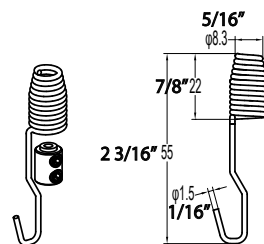

SPRING GRIPPING

Steel

Finish: Nickel Plating
For use with: Ball End, Cobra Cable, "J" Hook Cable, "P" Hook Cable
For Cable Diameter: 1/16" (2 mm)
Rated Strength: 15 Lbs (6 Kg)
For: Classic Rail, Ceiling Rail

Item#: SH100

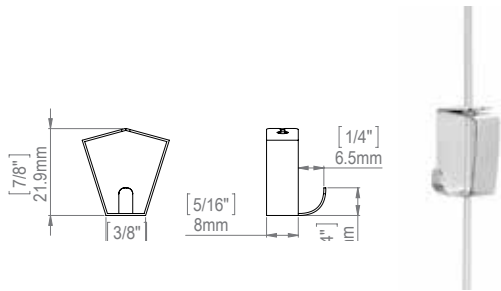

PICTURE STABILIZER

Size: 6 3/8"
Material: Steel
Finish: Nickel Plating
Item#: SPS100

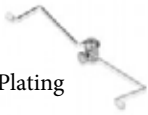

PICTURE STABILIZER

Size: 11 1/2"
Material: Steel
Finish: Nickel Plating
Item#: BPS100



SWAN HOOK

Material: Steel
Finish: Nickel Plating
Item#: SH101



SWAN HOOK

Material: Steel
Finish: Nickel Plating
Item#: SH102



HARDWARE

Locator

Aluminum

Finish: Nickel Plating
For use with: Easy Rail
Item#: CTL100

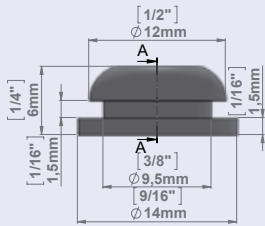

Connector for Easy Rail

Brass

For use with: Easy Rail
Item#: CTC100



	Item#	Screw	Anchor
	SADW6	Phillips Screw #6 x 1 1/4"	Rapid Anchor for Drywall
	SADW8	Phillips Screw #8 x 1 1/4"	Rapid Anchor for Drywall
	SACW6	Phillips Screw #6 x 1 1/4"	Anchor for Concrete
	SACW8	Phillips Screw #8 x 1 1/4"	Anchor for Concrete

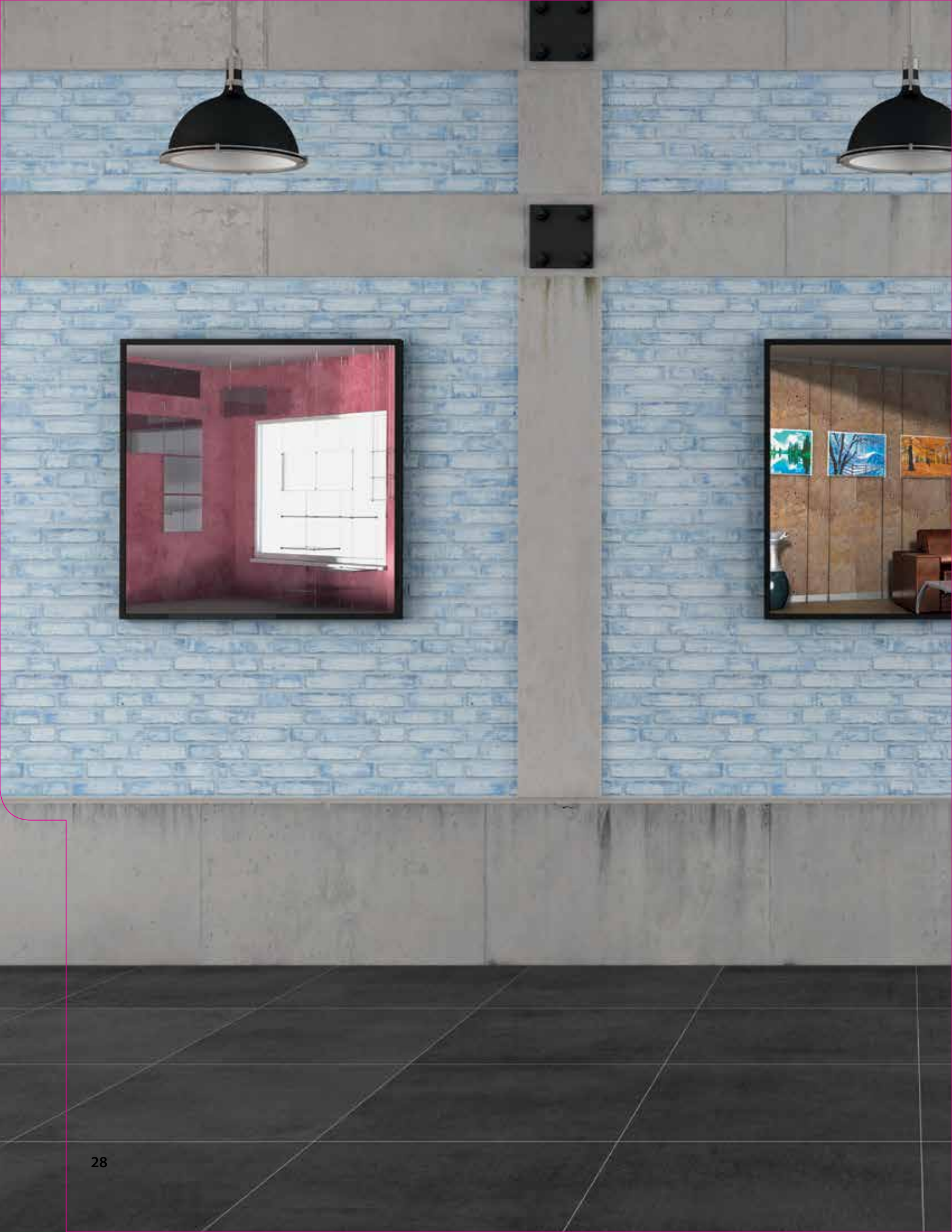

A modern interior space featuring a wall with horizontal bands of light blue brick and grey concrete panels. A black dome-shaped pendant light hangs from the ceiling. A framed purple square with white text is mounted on the brick wall. To the left, a mirror reflects a glimpse of another room with a lamp and a table. The floor is made of large, dark grey tiles.

CABLE SYSTEMS

Acrylic Sign Holders

Sign Holders for Inserts



This acrylic sign holder is ideal for displaying marketing materials. The 8.5"x11" top insert frame allows users to quickly and easily switch out signage selections. This sign holder that hangs in a cable system, also known as acrylic literature frame, is an exciting way to create signage in any environment.

Purchasers can use one of these literature frames or create a system by using multiple acrylic panels! This sign holder is made of crystal clear acrylic. Display is in stock, you can purchase today.

This fold-over sign holder can be mounted onto the cable system virtually anywhere to maximize viewing. These acrylic frames are ideal for use in retail stores, restaurants, and more! This sign holder that holds 8.5"x11" graphics is affordable and convenient! This panel holds singage in portrait orientation only. There is a large selection of acrylic poster frames and cable hanging systems in this online catalog. This acrylic sign holder is an impressive way to showcase 8.5"x11" graphics when combined with the cable hanging kit.

Mbs is proud to provide Cable & Rod Systems.

These systems are extremely versatile and create amazingly subtle displays that can be integrated into any environment. With so many applications including suspending, shelving, signage, decorative displays, showcase displays and graphic displays, Mbs is sure to meet your displays needs.



Acrylic Sign Holders

Sign Holders for Inserts



8.5" X 11" ACRYLIC SIGN HOLDER

Vertical Letter Holder

- 1 clear acrylic holder for letter sizes 8.5" x 11"
- With 2 magnets on the top to keep acrylic closed
- Acrylic only, hardware not included

AC8511

Acrylic Sign Holder

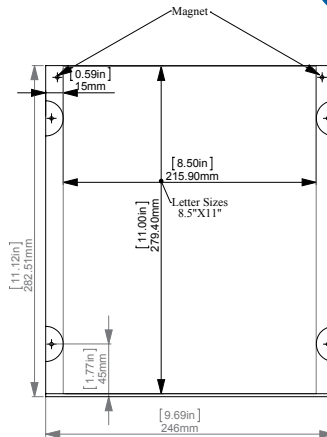

11" X 8½" ACRYLIC SIGN HOLDER

Horizontal Letter Holder

- 1 clear acrylic holder for letter sizes 11" x 8½"
- With 2 magnets on the top to keep acrylic closed
- Acrylic only, hardware not included

AC1185

Acrylic Sign Holder

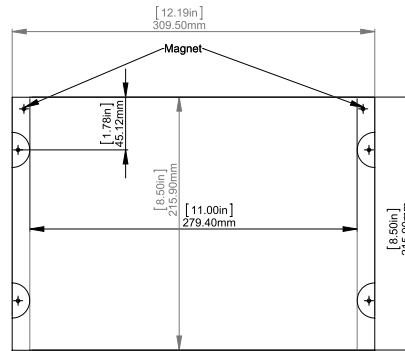

11" X 17" ACRYLIC SIGN HOLDER

Vertical Ledger Holder

- 1 clear acrylic holder for letter sizes 11" x 17"
- With 2 magnets on the top to keep acrylic closed
- Acrylic only, hardware not included

AC1117

Acrylic Sign Holder

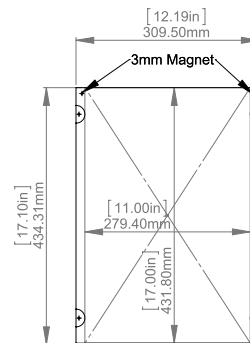

17" X 11" ACRYLIC SIGN HOLDER

Horizontal Ledger Holder

- 1 clear acrylic holder for letter sizes 17" x 11"
- With 2 magnets on the top to keep acrylic closed
- Acrylic only, hardware not included

AC1711

Acrylic Sign Holder

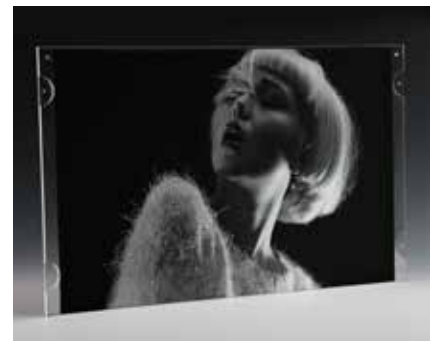
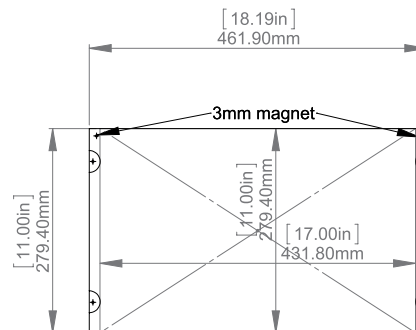

Acrylic Sign Holders

Sign Holders for Inserts



EXAMPLE

To do this set, you have to purchase 1 of the kit AC8511-2 and 2 extensions AC8511-2E



Watch Video



LED Poster Holder



Our backlit frames consist of two thin acrylic panels which form an illuminated sign less than ½" thick. Ceiling-to-floor, ceiling-to-wall, wall-to-floor or wall-to-wall cable systems are a unique, modern and eye appealing way to suspend graphics in storefront windows.

Our polished silver cable system components create a great contrast with the blackface of backlit frames.

LED backlighting is also energy efficient and reduces your energy cost as well as your carbon foot print.

Our backlit frames, similar to light boxes, illuminate graphics printed on translucent materials. This technology will help you increase your exposure and visibility.

Not only will the bright LED illumination draw your customer's attention, it will also allow you to build a repeat customer base by offering your products and/or services utilizing this unique and modern design. The "suspended in mid-air" look, will catch your customer's eye and retain their attention with its sleek and classy appearance.

Each sign panel is held together with decorative hardware and has backers with illuminated beveled edges.

The acrylic overlay has an opaque black border that deflects the edge lighting. The result is a soft glow around the acrylic backlit frames which increases its visual appeal.

As a user, you will find that the LED lighting provides a distinct upgrade in display quality as well as brightness and definition in comparison to traditional neon signage or fluorescent bulbs.

Today's consumers are increasingly aware of environmental issues and are rewarding companies who take the proper steps to minimize pollution and their overall negative impact on our planet. Our LED products will provide you with that edge and will send a positive message to your customers.

Please Note: Posters printed on a translucent material are recommended for use in these light boxes in order to maximize the effect created by the LED backlighting.

ACCESSORIES



Power Connector

For wire: AWG 14
(low tension 12-24V)
For cable diameter: ¼" (1.50 mm)

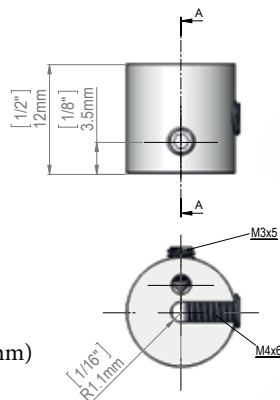

ACA1212	Aluminum Clear Anodized
---------	-------------------------



Transformer

TR01-1: AC/DC adapter for 1 LED panel
TR01-2: AC/DC adapter for 2 LED panel
TR01-4: AC/DC adapter for 3-4 LED panel

TR01	Transformer
------	-------------

1/16" Diameter Multi Function Cable Kits

Wall to Wall, Ceiling to Floor, Wall to Floor, Wall to Ceiling



MULTI FUNCTION CABLE KIT

Aluminum

Aluminum mounted kit includes:

- 2 adjustable mounts
- 1 cable 13'1" long, diameter 1/16" (1.50 mm) made from galvanized steel
- Spring tension adjuster
- Mounting hardware

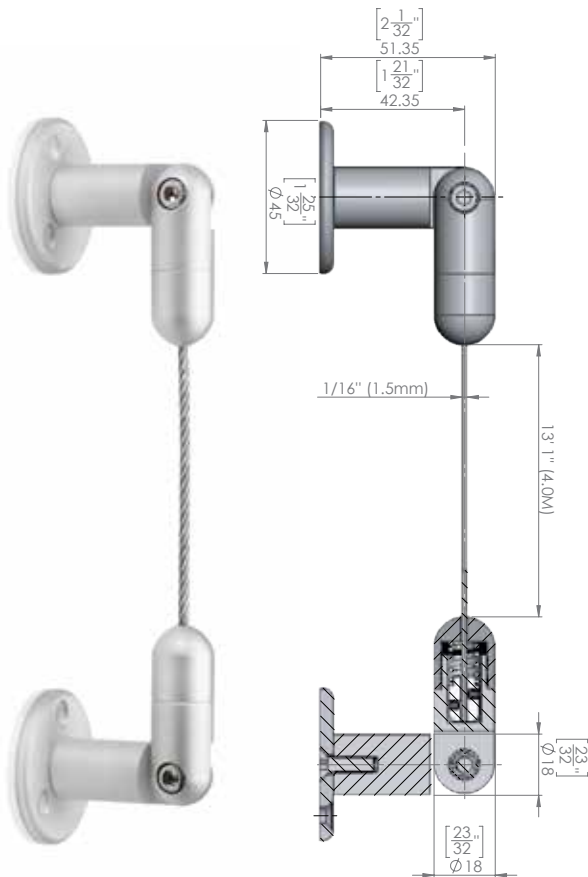

CS15A

Aluminum Clear Anodized

MULTI FUNCTION CABLE KIT

Stainless Steel

Stainless steel mounted kit includes:

- 2 adjustable mounts
- 1 cable 13'1" long, diameter 1/16" (1.50 mm) made from galvanized steel
- Spring tension adjuster
- Mounting hardware

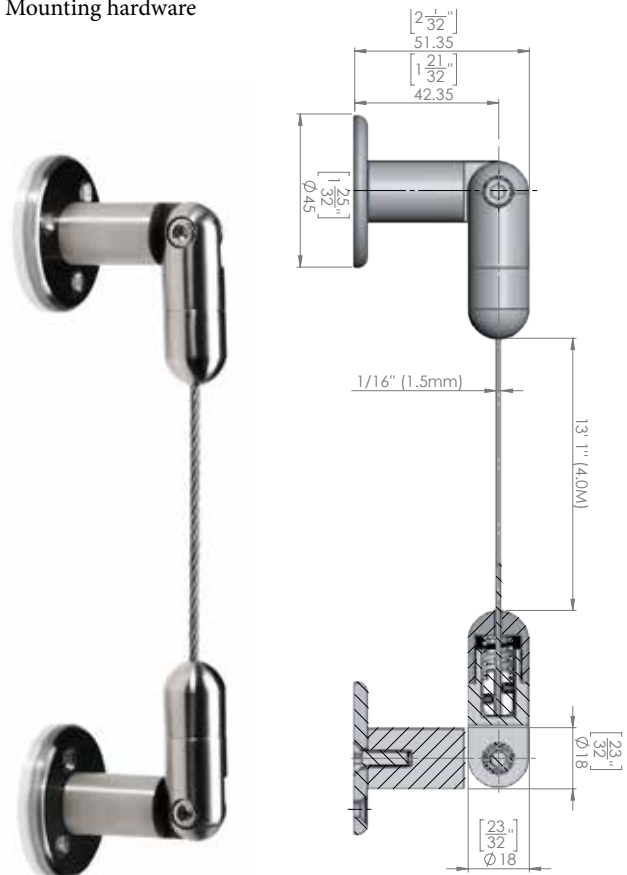

CS15

Satin Stainless Steel

ADJUSTABLE ANGLE UP TO 90°



1/16" Diameter Cable Kits

For Signage, Display, Poster, Graphic, etc...

Aluminum kits come with a galvanized steel cable. Stainless steel kits come with a stainless steel cable. Composed of 7 strands, each strand is composed of 7 wires, which gives us a total of 49 steel wires twisted together. The cable thickness is 1/16" (approximately: 1.50 mm). Each cable can be loaded with up to 55 lbs (approximately 115 kg).

The lengths of the other systems, for wall or open area application, are indicated inside this section. Extra cables can be added to any cable systems upon request.

All of the cable systems shown in this section must be anchored into a solid material or can be mounted on our aluminum track for mobility.

CEILING TO FLOOR MOUNTED KIT

Aluminum

Aluminum ceiling to floor mounted kit includes:

- 1 ceiling mount
- 1 cable 13'1" long, diameter 1/16" (1.50 mm) made from galvanized steel
- 1 tension adjuster
- Aluminum includes screw and anchor

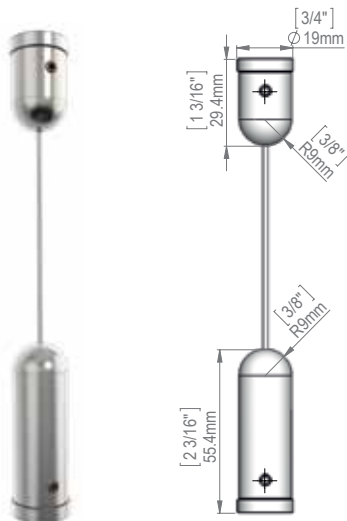

ACG1904

Aluminum Clear Anodized

CEILING TO FLOOR MOUNTED KIT

Stainless Steel

Stainless steel ceiling to floor mounted kit includes:

- 1 ceiling mount
- 1 cable 16'4" long, diameter 1/16" (1.50 mm) made from galvanized steel
- 1 tension adjuster
- Mounting hardware not included

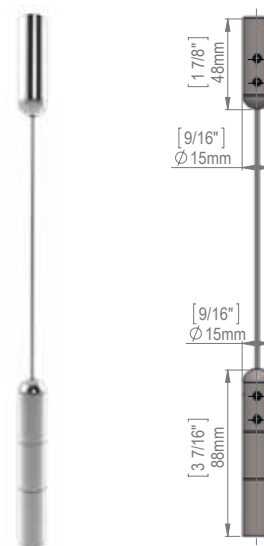

SCG1904

Satin Stainless Steel

1/16" Diameter Cable Kits

For Signage, Display, Poster, Graphic, etc...

CEILING TO WALL / WALL TO FLOOR MOUNTED KIT Aluminum

Aluminum mounted kit includes:

- 1 mount
- 1 cable 13'1" long, diameter 1/16" (1.50 mm) made from galvanized steel
- 1 tension adjuster, 1 horizontal arm,
- 1 washer stabilizer
- Aluminum includes screw and anchor

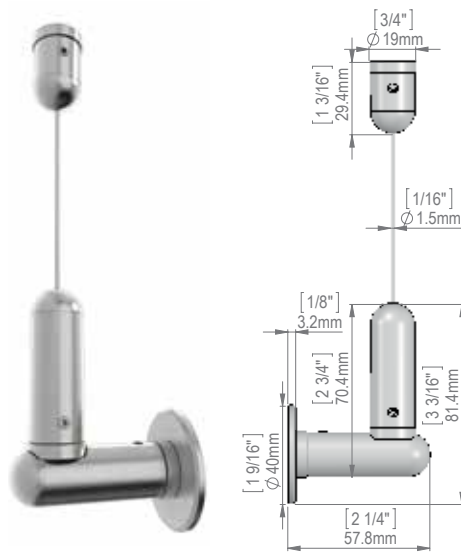

ACG1907

Aluminum Clear Anodized

CEILING TO WALL / WALL TO FLOOR MOUNTED KIT Stainless Steel

Stainless steel mounted kit includes:

- 1 mount
- 1 cable 16'4" long, diameter 1/16" (1.50 mm) made from stainless steel
- 1 tension adjuster, 1 horizontal arm,
- 1 washer stabilizer
- Mounting hardware not included

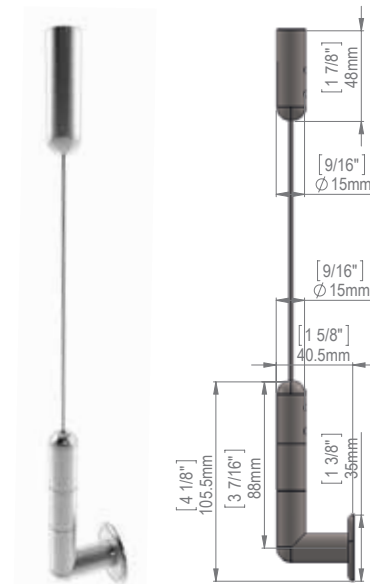

SCG1907

Satin Stainless Steel



1/16" Diameter Cable Kits

For Signage, Display, Poster, Graphic, etc...

WALL TO WALL MOUNTED KIT Aluminum

Aluminum mounted kit includes:

- 2 mounts
- 1 cable 13'1" long, diameter 1/16" (1.50 mm) made from galvanized steel
- 1 tension adjuster, 1 horizontal arm
- 2 washer stabilizer
- Aluminum includes screw and anchor

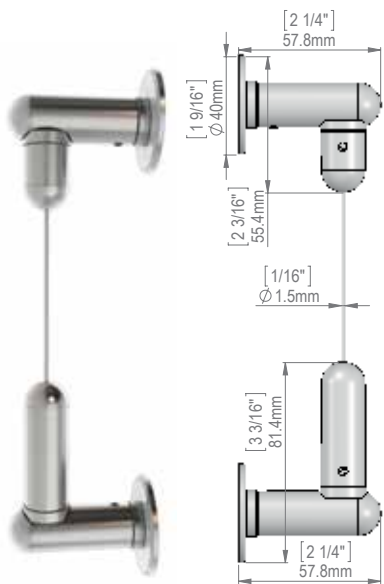

ACG1908

Aluminum Clear Anodized

WALL TO WALL MOUNTED KIT Stainless Steel

Stainless steel mounted kit includes:

- 2 mounts
- 1 cable 16'4" long, diameter 1/16" (1.50 mm) made from galvanized steel
- 1 tension adjuster, 1 horizontal arm
- 2 washer stabilizer
- Mounting hardware not included

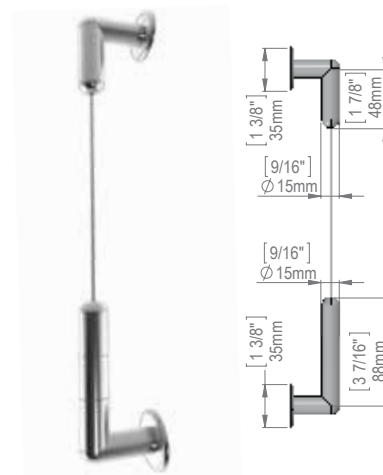

SCG1908

Satin Stainless Steel



SPECIAL DESIGN, SPECIAL REQUESTS

Please Call Us!

1-813-938-6025

Our Signage Hardware Experts
Will Be Happy To Assist You!

Panel Grips for $\frac{1}{16}$ " Diameter Cable Kits

Thickness: Minimum $\frac{1}{16}$ " to Maximum $\frac{3}{16}$ "

VERTICAL SUPPORT

Single Sided

Panel thickness: minimum $\frac{1}{16}$ " (1.50 mm), maximum $\frac{3}{16}$ " (5 mm)

Cable spacing: panel width plus $\frac{3}{16}$ " (5.50 mm)

For cable diameter: $\frac{1}{16}$ " (1.5 mm)

150.006 Stainless Steel Satin Finish

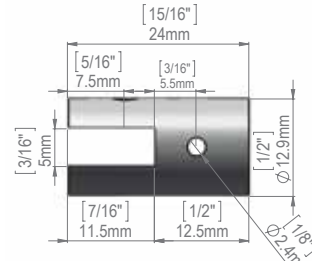

VERTICAL SUPPORT

Double Sided

Panel thickness: minimum $\frac{1}{16}$ " (1.50 mm), maximum $\frac{3}{16}$ " (5 mm)

Cable spacing: panel width plus $\frac{3}{8}$ " (11 mm)

For cable diameter: $\frac{1}{16}$ " (1.5 mm)

150.016 Stainless Steel Satin Finish

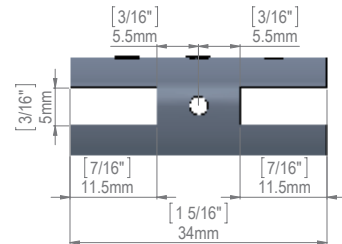
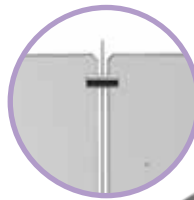

VERTICAL SUPPORT

Single Sided

Panel thickness: minimum $\frac{1}{16}$ " (1.50 mm), maximum $\frac{3}{16}$ " (4.50 mm)

Cable spacing: panel width plus $\frac{5}{16}$ " (8 mm)

For cable diameter: $\frac{1}{16}$ " (1.5 mm)

ACA1016 Aluminum Clear Anodized

SCA1016 Stainless Steel Satin Finish

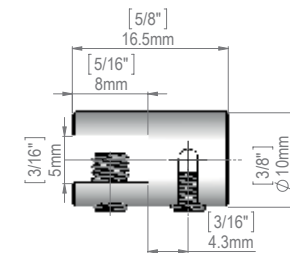
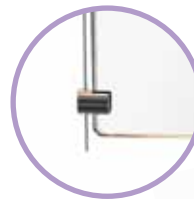

VERTICAL SUPPORT

Double Sided

Panel thickness: minimum $\frac{1}{16}$ " (1.50 mm), maximum $\frac{3}{16}$ " (4.50 mm)

Cable spacing: panel width plus $\frac{5}{16}$ " (8 mm)

For cable diameter: $\frac{1}{16}$ " (1.5 mm)

ACA1023 Aluminum Clear Anodized

SCA1023 Stainless Steel Satin Finish

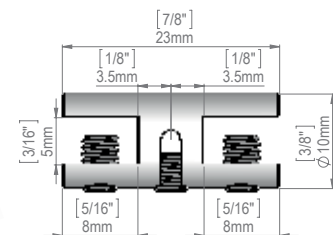
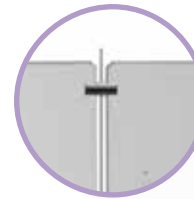

Panel Grips for 1/16" Diameter Cable Kits

Thickness: Minimum 1/8" to Maximum 3/8"

VERTICAL SUPPORT

Single Sided

Panel thickness: minimum 1/8" (3 mm),
maximum 3/8" (9 mm)

Cable spacing: panel width plus 3/8" (10 mm)

For cable diameter: 1/16" (1.5 mm)

ACA1610	Aluminum Clear Anodized
SCA1610	Stainless Steel Satin Finish

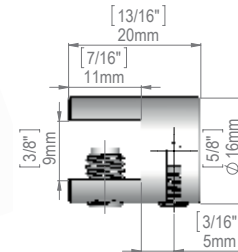

VERTICAL SUPPORT

Double Sided

Panel thickness: minimum 1/8" (3 mm),
maximum 3/8" (9 mm)

Cable spacing: panel width plus 3/8" (10 mm)

For cable diameter: 1/16" (1.5 mm)

ACA1612	Aluminum Clear Anodized
SCA1612	Stainless Steel Satin Finish

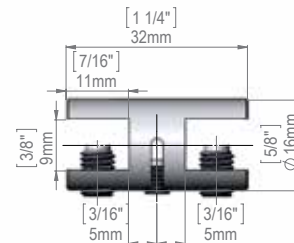

PIVOTING SUPPORT

Single Sided

Panel thickness: minimum 1/8" (3 mm),
maximum 3/8" (9 mm)

Cable spacing: panel width plus 1" (25.4 mm)

For cable diameter: 1/16" (1.5 mm)

ACA1620	Aluminum Clear Anodized
SCA1620	Stainless Steel Satin Finish

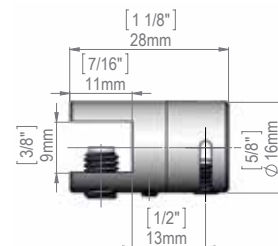
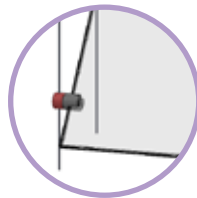

PIVOTING SUPPORT

Double Sided

Panel thickness: minimum 1/8" (3 mm),
maximum 3/8" (9 mm)

Cable spacing: panel width plus 1" (25.4 mm)

For cable diameter: 1/16" (1.5 mm)

ACA1622	Aluminum Clear Anodized
SCA1622	Stainless Steel Satin Finish

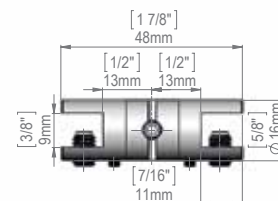

Panel Grips for $\frac{1}{16}$ " Diameter Cable Kits

PIVOTING SUPPORT

Single Sided

Panel thickness: minimum $\frac{3}{16}$ " (4 mm),
maximum $\frac{1}{2}$ " (12.7 mm)

Cable spacing: panel width plus 1" (25.4 mm)

For cable diameter: $\frac{1}{16}$ " (1.5 mm)

ACA2010	Aluminum Clear Anodized
SCA2010	Stainless Steel Satin Finish

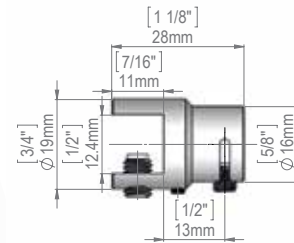
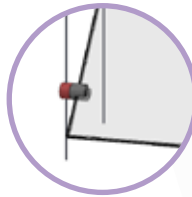

PIVOTING SUPPORT

Double Sided

Panel thickness: minimum $\frac{3}{16}$ " (4 mm),
maximum $\frac{1}{2}$ " (12.7 mm)

Cable spacing: panel width plus 1" (25.4 mm)

For cable diameter: $\frac{1}{16}$ " (1.5 mm)

ACA2012	Aluminum Clear Anodized
SCA2012	Stainless Steel Satin Finish

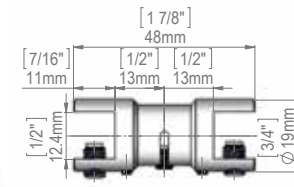

STANDOFF PANEL SUPPORT

Single Sided

Panel thickness: minimum $\frac{1}{8}$ " (3 mm),
maximum $\frac{1}{4}$ " (6.35 mm)

Panel drill hole: $\frac{1}{4}$ " (5.5 mm)

For cable diameter: $\frac{1}{16}$ " (1.5 mm)

ACA1640	Aluminum Clear Anodized
SCA1640	Stainless Steel Satin Finish
SRA1640-H12	Extended Head

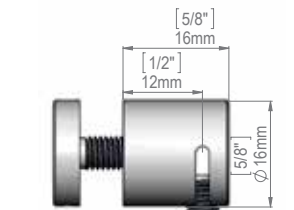
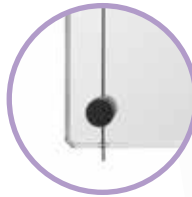

STANDOFF PANEL SUPPORT

Double Sided

Panel thickness: minimum $\frac{1}{8}$ " (3 mm),
maximum $\frac{1}{4}$ " (6.35 mm)

Panel drill hole: $\frac{1}{4}$ " (5.5 mm)

For cable diameter: $\frac{1}{16}$ " (1.5 mm)

ACA1642	Aluminum Clear Anodized
SCA1642	Stainless Steel Satin Finish
SRA1640-H12	Extended Head

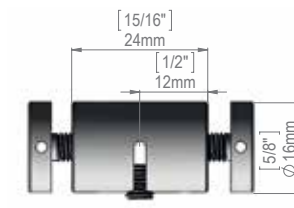
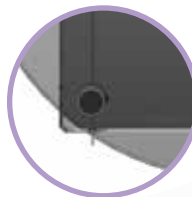

Panel Grips for 1/16" Diameter Cable Kits

Thickness: Minimum 1/8" to Maximum 3/8"

EDGE SUPPORT

Single Sided

Panel thickness: minimum 1/8" (3 mm),
maximum 3/8" (10 mm)

For cable diameter: 1/16" (1.5 mm)

ACA1630	Aluminum Clear Anodized
SCA1630	Stainless Steel Satin Finish

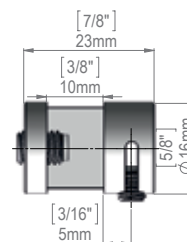
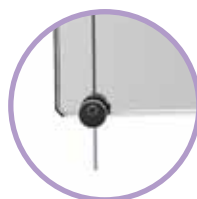

EDGE PIVOTING SUPPORT

Single Sided

Panel thickness: minimum 1/8" (3 mm),
maximum 3/8" (10 mm)

For cable diameter: 1/16" (1.5 mm)

ACA1631	Aluminum Clear Anodized
SCA1631	Stainless Steel Satin Finish

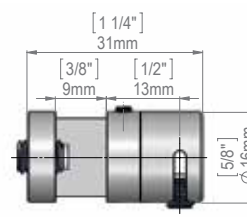
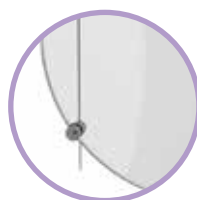

EDGE PIVOTING SUPPORT

Double Sided

Panel thickness: minimum 1/8" (3 mm),
maximum 3/8" (10 mm)

For cable diameter: 1/16" (1.5 mm)

ACA1632	Aluminum Clear Anodized
SCA1632	Stainless Steel Satin Finish

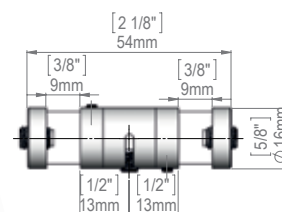
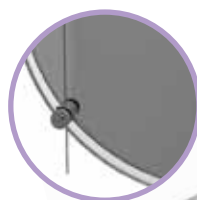

Horizontal Shelf for $\frac{1}{16}$ " Diameter Cable Supports

SHELF SUPPORT

Shelf thickness: minimum $\frac{1}{8}$ " (3 mm)
 Panel drill hole: $\frac{1}{4}$ " (5.5 mm)
 For cable diameter: $\frac{1}{16}$ " (1.5 mm)

ACA1650	Aluminum Clear Anodized
SCA1650	Stainless Steel Satin Finish

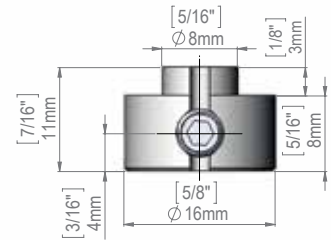

HORIZONTAL SUPPORT Single Sided Shelf Grip

Shelf thickness: minimum $\frac{1}{8}$ " (3 mm),
 maximum $\frac{3}{8}$ " (9 mm)
 Cable spacing: shelf width plus $\frac{3}{8}$ "
 (10 mm)
 For cable diameter: $\frac{1}{16}$ " (1.5 mm)

ACB1610	Aluminum Clear Anodized
SCB1610	Stainless Steel Satin Finish

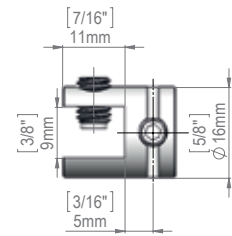

HORIZONTAL SUPPORT Double Sided Shelf Grip

Shelf thickness: minimum $\frac{1}{8}$ " (3 mm),
 maximum $\frac{3}{8}$ " (9 mm)
 Cable spacing: shelf width plus $\frac{3}{8}$ "
 (10 mm)
 For cable diameter: $\frac{1}{16}$ " (1.5 mm)

ACB1612	Aluminum Clear Anodized
SCB1612	Stainless Steel Satin Finish

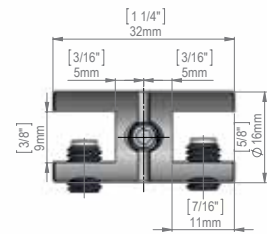
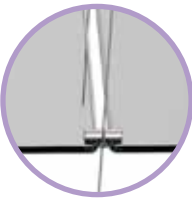

Shelf Supports for 1/16" Diameter Cable Supports

SHELF PIVOTING Support Single Sided

Shelf thickness: minimum 1/4" (6.35 mm),
maximum 3/4" (19 mm)
For cable diameter: 1/16" (1.5 mm)

ACA1651	Aluminum Clear Anodized
SCA1651	Stainless Steel Satin Finish

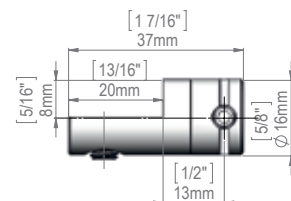

SHELF PIVOTING Support Double Sided

Shelf thickness: minimum 1/4" (6.35 mm),
maximum 3/4" (19 mm)
For cable diameter: 1/16" (1.5 mm)

ACA1652	Aluminum Clear Anodized
SCA1652	Stainless Steel Satin Finish

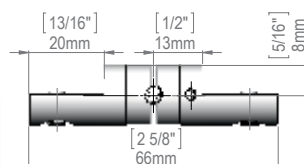

RETAINER SCREW For Pivoting Support

Shelf thickness: minimum 1/8" (3 mm),
maximum 3/4" (9 mm)
Panel drill hole: 1/4" (5.5 mm)
For parts: ACA1651, ACA1652, SCA1651,
SCA1652

ACA1653	Aluminum Clear Anodized
SCA1653	Stainless Steel Satin Finish

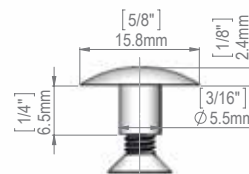

1/8" Diameter Multi Function Cable Kits



Wall to Wall, Ceiling to Floor, Wall to Floor, Wall to Ceiling

Aluminum kits come with a galvanized steel cable. Stainless steel kits come with a stainless steel cable. Composed of 7 strands, each strand is composed of 7 wires, which gives us a total of 49 steel wires twisted together. The cable thickness is 1/8" (approximately: 3 mm). Each cable can be loaded with up to 78 lbs (approximately 230 kg).

The lengths of the other systems, for wall or open area application, are indicated inside this section. Extra cables can be added to any cable systems upon request.

All of the cable systems shown in this section must be anchored into a solid material or can be mounted on our aluminum track for mobility.

MULTI FUNCTION CABLE KIT

Aluminum

Aluminum mounted kit includes:

- 2 adjustable mounts
- 1 cable 13'1" long, diameter 1/8" (3 mm) made from stainless steel
- Spring tension adjuster
- Mounting hardware

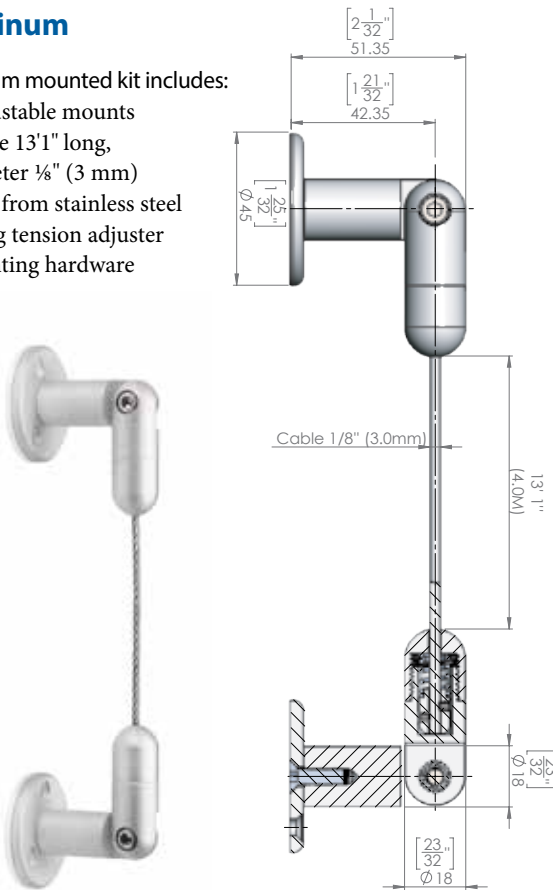

CS3A

Aluminum Clear Anodized

MULTI FUNCTION CABLE KIT

Stainless Steel

Stainless steel mounted kit includes:

- 2 adjustable mounts
- 1 cable 13'1" long, diameter 1/8" (3 mm) made from stainless steel
- Spring tension adjuster
- Mounting hardware



CS3

Satin Stainless Steel

ADJUSTABLE ANGLE UP TO 90°



Panel Grips for 1/8" Diameter Cable Supports



Thickness: Minimum 1/8" to Maximum 3/8"

VERTICAL SUPPORT

Single Sided

Panel thickness: minimum 1/8" (3 mm), maximum 3/8" (9 mm)

Cable spacing: panel width plus 3/8" (10 mm)

For cable diameter: 1/8" (3 mm)

ACA31610	Aluminum Clear Anodized
SCA31610	Stainless Steel Satin Finish

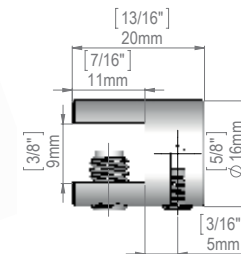

VERTICAL SUPPORT

Double Sided

Panel thickness: minimum 1/8" (3 mm), maximum 3/8" (9 mm)

Cable spacing: panel width plus 3/8" (10 mm)

For cable diameter: 1/8" (3 mm)

ACA31612	Aluminum Clear Anodized
SCA31612	Stainless Steel Satin Finish

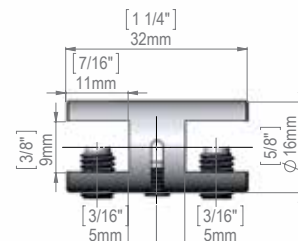
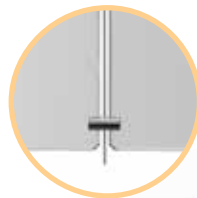

PIVOTING SUPPORT

Single Sided

Panel thickness: minimum 1/8" (3 mm), maximum 3/8" (9 mm)

Cable spacing: panel width plus 1" (25.4 mm)

For cable diameter: 1/8" (3 mm)

ACA31620	Aluminum Clear Anodized
SCA31620	Stainless Steel Satin Finish

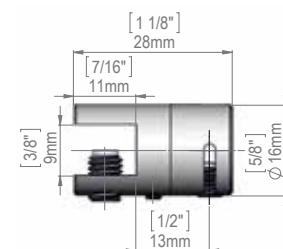
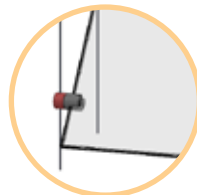

PIVOTING SUPPORT

Double Sided

Panel thickness: minimum 1/8" (3 mm), maximum 3/8" (9 mm)

Cable spacing: panel width plus 1" (25.4 mm)

For cable diameter: 1/8" (3 mm)

ACA31622	Aluminum Clear Anodized
SCA31622	Stainless Steel Satin Finish

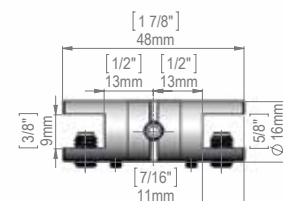

Panel Grips for 1/8" Diameter Cable Supports

PIVOTING SUPPORT

Single Sided

Panel thickness: minimum 3/16" (4 mm),
maximum 1/2" (12.7 mm)

Cable spacing: panel width plus 1" (25.4 mm)

For cable diameter: 1/8" (3 mm)

ACA32010	Aluminum Clear Anodized
SCA32010	Stainless Steel Satin Finish

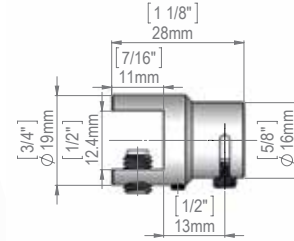
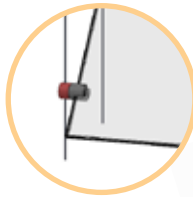

PIVOTING SUPPORT

Double Sided

Panel thickness: minimum 3/16" (4 mm),
maximum 1/2" (12.7 mm)

Cable spacing: panel width plus 1" (25.4 mm)

For cable diameter: 1/8" (3 mm)

ACA32012	Aluminum Clear Anodized
SCA32012	Stainless Steel Satin Finish

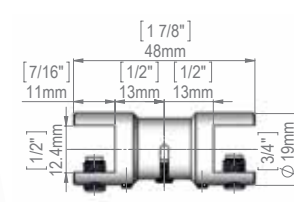

STANDOFF PANEL SUPPORT

Single Sided

Panel thickness: minimum 1/8" (3 mm),
maximum 1/4" (6.35 mm)

Panel drill hole: 1/4" (5.5 mm)

For cable diameter: 1/8" (3 mm)

ACA31640	Aluminum Clear Anodized
SCA31640	Stainless Steel Satin Finish

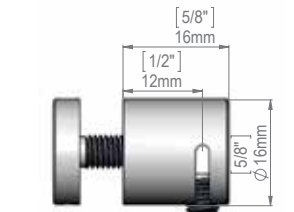
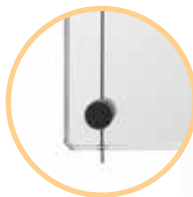

STANDOFF PANEL SUPPORT

Double Sided

Panel thickness: minimum 1/8" (3 mm),
maximum 1/4" (6.35 mm)

Panel drill hole: 1/4" (5.5 mm)

For cable diameter: 1/8" (3 mm)

ACA31642	Aluminum Clear Anodized
SCA31642	Stainless Steel Satin Finish

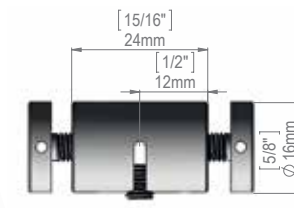
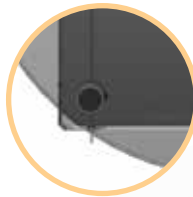

Panel Grips for 1/8" Diameter Cable Supports

EDGE SUPPORT

Single Sided

Panel thickness: minimum 1/8" (3 mm),
maximum 3/8" (10 mm)

For cable diameter: 1/8" (3 mm)

ACA31630 Aluminum Clear Anodized

SCA31630 Stainless Steel Satin Finish

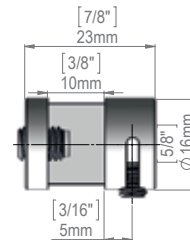

EDGE PIVOTING SUPPORT

Single Sided

Panel thickness: minimum 1/8" (3 mm),
maximum 3/8" (10 mm)

For cable diameter: 1/8" (3 mm)

ACA31631 Aluminum Clear Anodized

SCA31631 Stainless Steel Satin Finish

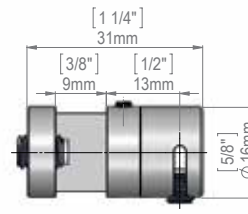

EDGE PIVOTING SUPPORT

Double Sided

Panel thickness: minimum 1/8" (3 mm),
maximum 3/8" (10 mm)

For cable diameter: 1/8" (3 mm)

ACA31632 Aluminum Clear Anodized

SCA31632 Stainless Steel Satin Finish

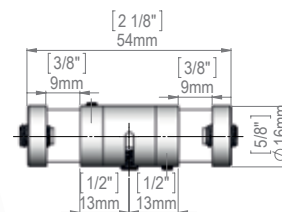
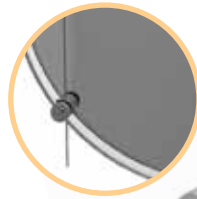

Horizontal Shelf for 1/8" Diameter Cable Supports

SHELF SUPPORT

Shelf thickness: minimum 1/8" (3 mm)
 Panel drill hole: 1/4" (5.5 mm)
 For cable diameter: 1/8" (3 mm)

ACA31650	Aluminum Clear Anodized
SCA31650	Stainless Steel Satin Finish

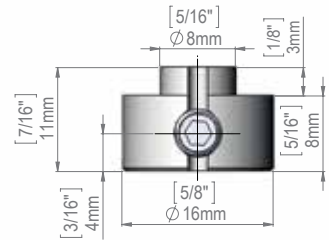

HORIZONTAL SUPPORT Single Sided Shelf Grip

Shelf thickness: minimum 1/8" (3 mm),
 maximum 3/8" (9 mm)
 Cable spacing: shelf width plus 3/8" (10 mm)
 For cable diameter: 1/8" (3 mm)

ACB31631	Aluminum Clear Anodized
SCB31631	Stainless Steel Satin Finish

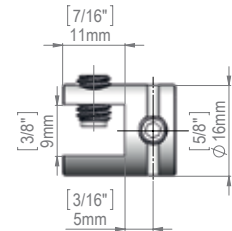

HORIZONTAL SUPPORT Double Sided Shelf Grip

Shelf thickness: minimum 1/8" (3 mm),
 maximum 3/8" (9 mm)
 Cable spacing: shelf width plus 3/8" (10 mm)
 For cable diameter: 1/8" (3 mm)

ACB31632	Aluminum Clear Anodized
SCB31632	Stainless Steel Satin Finish

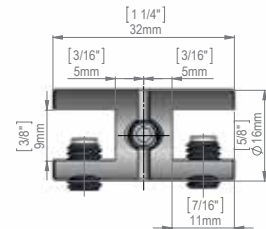
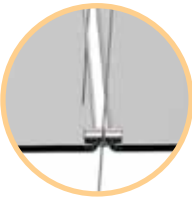

Shelf Supports for 1/8" Diameter Cable Supports

SHELF PIVOTING Support Single Sided

Shelf thickness: minimum 1/4" (6.35 mm),
maximum 3/4" (19 mm)
For cable diameter: 1/8" (3 mm)

ACA31651	Aluminum Clear Anodized
SCA31651	Stainless Steel Satin Finish

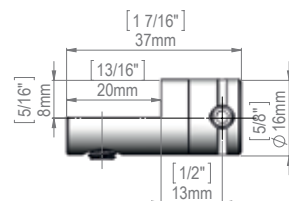

SHELF PIVOTING Support Double Sided

Shelf thickness: minimum 1/4" (6.35 mm),
maximum 3/4" (19 mm)
For cable diameter: 1/8" (3 mm)

ACA31652	Aluminum Clear Anodized
SCA31652	Stainless Steel Satin Finish

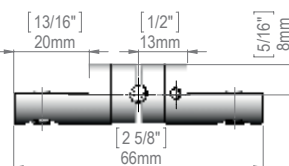

RETAINER SCREW For Pivoting Support

Shelf thickness: minimum 1/8" (3 mm),
maximum 3/4" (9 mm)
Panel drill hole: 1/4" (5.5 mm)
For parts: ACA1651, ACA1652, SCA1651,
SCA1652

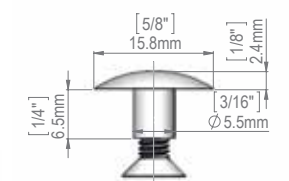

ACA31653	Aluminum Clear Anodized
SCA31653	Stainless Steel Satin Finish

1/4" Rod Kits

For Signage, Display, Poster, Graphic, etc...

CEILING TO FLOOR MOUNTED KIT Aluminum

Aluminum mounted kit includes:

- 1 ceiling mount
- 1 rod
- 1 tension adjuster
- ARG1904-1 set with rod length L: 3'3" (1 m)
- ARG1904-2 set with rod length L: 4'11" (1.5 m)
- ARG1904-3 set with rod length L: 6'6" (2 m)
- ARG1904-4 set with rod length L: 8'2" (2.5 m)
- Aluminum includes screw and anchor

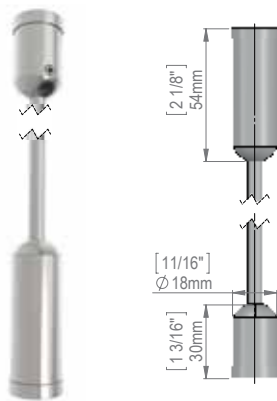

ARG1904-**

Aluminum Clear Anodized

CEILING TO FLOOR MOUNTED KIT Stainless Steel

Stainless steel mounted kit includes:

- 1 ceiling mount
- 1 rod
- 1 tension adjuster
- SRG1904-1 set with rod length L: 3'3" (1 m)
- SRG1904-2 set with rod length L: 4'11" (1.5 m)
- SRG1904-3 set with rod length L: 6'6" (2 m)
- SRG1904-4 set with rod length L: 8'2" (2.5 m)
- Mounting hardware not included

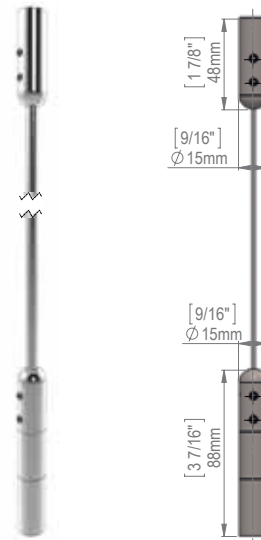

SRG1904-**

Stainless Steel Satin Finish



1/4" Rod Kits

For Signage, Display, Poster, Graphic, etc...

CEILING TO WALL / WALL TO FLOOR MOUNTED KIT Aluminum

Aluminum mounted kit includes:

- 1 mount
- 1 rod
- 1 tension adjuster, 1 horizontal arm
- 1 washer stabilizer
- ARG1905-1 set with rod length L: 3'3" (1 m)
- ARG1905-2 set with rod length L: 4'11" (1.5 m)
- ARG1905-3 set with rod length L: 6'6" (2 m)
- ARG1905-4 set with rod length L: 8'2" (2.5 m)
- Aluminum includes screw and anchor

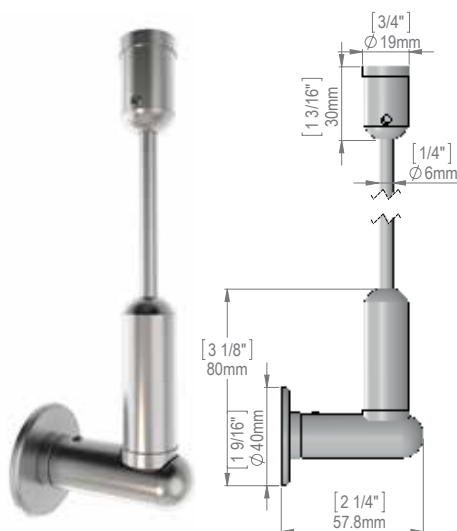

ARG1905-**

Aluminum Clear Anodized

CEILING TO WALL / WALL TO FLOOR MOUNTED KIT Stainless Steel

Stainless steel mounted kit includes:

- 1 mount
- 1 rod
- 1 tension adjuster, 1 horizontal arm
- 1 washer stabilizer
- SRG1905-1 set with rod length L: 3'3" (1 m)
- SRG1905-2 set with rod length L: 4'11" (1.5 m)
- SRG1905-3 set with rod length L: 6'6" (2 m)
- SRG1905-4 set with rod length L: 8'2" (2.5 m)
- Mounting hardware not included

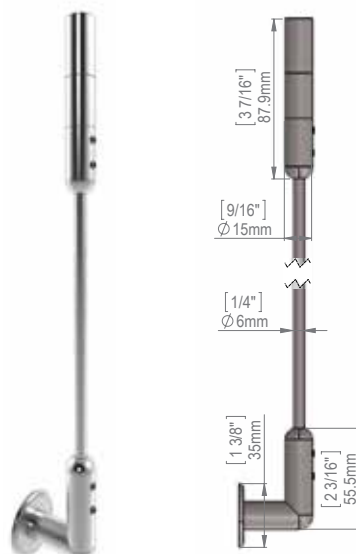

SRG1905-**

Stainless Steel Satin Finish



1/4" Rod Kits

For Signage, Display, Poster, Graphic, etc...

WALL TO WALL MOUNTED KIT

Aluminum

Aluminum mounted kit includes:

- 2 washer stabilizer, 2 horizontal arm, 2 ceiling mounted
- 1 rod
- 1 tension adjuster
- ARG1907-1 set with rod length L: 3'3" (1 m)
- ARG1907-2 set with rod length L: 4'11" (1.5 m)
- ARG1907-3 set with rod length L: 6'6" (2 m)
- ARG1907-4 set with rod length L: 8'2" (2.5 m)
- Aluminum includes screw and anchor

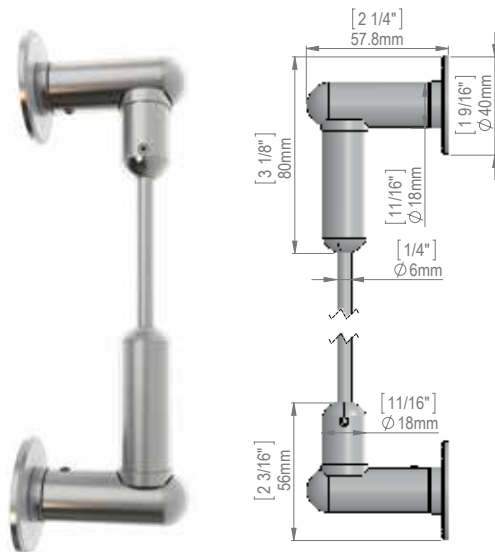

ARG1907

Aluminum Clear Anodized

WALL TO WALL MOUNTED KIT

Stainless Steel

Stainless steel mounted kit includes:

- 2 washer stabilizer, 2 horizontal arm, 2 ceiling mounted
- 1 rod
- 1 tension adjuster
- SRG1907-1 set with rod length L: 3'3" (1 m)
- SRG1907-2 set with rod length L: 4'11" (1.5 m)
- SRG1907-3 set with rod length L: 6'6" (2 m)
- SRG1907-4 set with rod length L: 8'2" (2.5 m)
- Mounting hardware not included

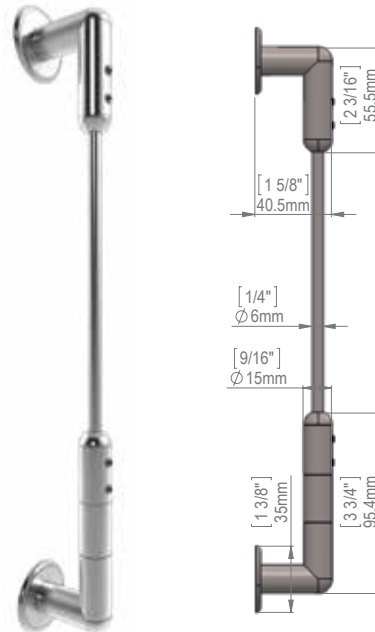

SRG1907

Stainless Steel Satin Finish



Panel Grips for 1/4" Rod Support

VERTICAL SUPPORT

Single Sided

Panel thickness: minimum 1/8" (3 mm),
maximum 1/4" (6.35 mm)

Rod spacing: panel width plus 1/16"
(14 mm)

For rod diameter: 1/4" (6 mm)

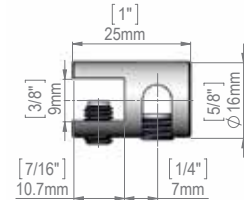

ARA1610	Aluminum Clear Anodized
SRA1610	Stainless Steel Satin Finish

VERTICAL SUPPORT

Double Sided

Panel thickness: minimum 1/8" (3 mm),
maximum 1/4" (6.35 mm)

Rod spacing: panel width plus 1/16"
(14 mm)

For rod diameter: 1/4" (6 mm)

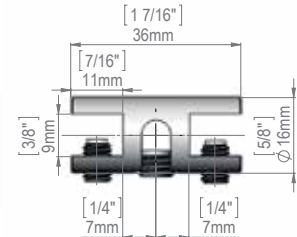
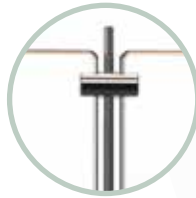

ARA1612	Aluminum Clear Anodized
SRA1612	Stainless Steel Satin Finish

PIVOTING SUPPORT

Single Sided

Panel thickness: minimum 1/8" (3 mm),
maximum 3/8" (9.52 mm)

Rod spacing: panel width plus 1/16"
(14 mm)

For rod diameter: 1/4" (6 mm)

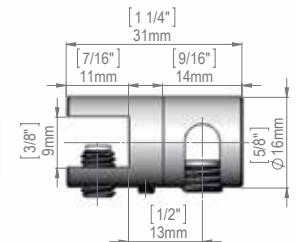
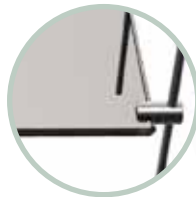

ARA1620	Aluminum Clear Anodized
SRA1620	Stainless Steel Satin Finish

PIVOTING SUPPORT

Double Sided (Large)

Panel thickness: minimum 1/8" (3 mm),
maximum 3/8" (9.52 mm)

Rod spacing: panel width plus 1/16"
(14 mm)

For rod diameter: 1/4" (6 mm)

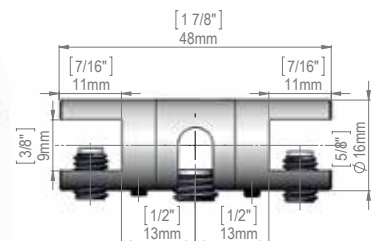
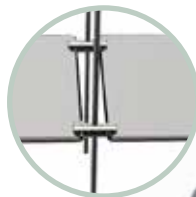

ARA1622	Aluminum Clear Anodized
SRA1622	Stainless Steel Satin Finish

Panel Grips for 1/4" Rod Support

PIVOTING SUPPORT

Single Sided

Panel thickness: minimum 3/16" (4 mm),
maximum 1/2" (12.7 mm)

Cable spacing: panel width plus 1" (25.4 mm)

For rod diameter: 1/4" (6 mm)

ARA2010	Aluminum Clear Anodized
SRA2010	Stainless Steel Satin Finish

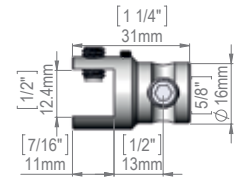

PIVOTING SUPPORT

Double Sided

Panel thickness: minimum 3/16" (4 mm),
maximum 1/2" (12.7 mm)

Cable spacing: panel width plus 1" (25.4 mm)

For rod diameter: 1/4" (6 mm)

ARA2012	Aluminum Clear Anodized
SRA2012	Stainless Steel Satin Finish

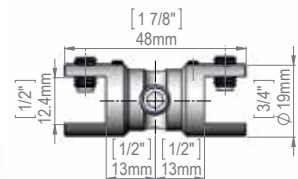

STANDOFF PANEL SUPPORT

Single Sided

Panel thickness: minimum 1/8" (3 mm),
maximum 1/4" (6.35 mm)

Panel drill hole: 1/4" (6.35 mm)

For rod diameter: 1/4" (6 mm)

ARA1640	Aluminum Clear Anodized
SRA1640	Stainless Steel Satin Finish
SRA1640-H12	Extended Head

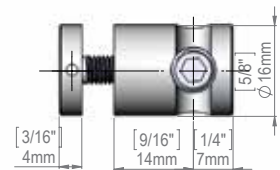

STANDOFF PANEL SUPPORT

Double Sided

Panel thickness: minimum 1/8" (3 mm),
maximum 1/4" (6.35 mm)

Panel drill hole: 1/4" (6.35 mm)

For rod diameter: 1/4" (6 mm)

ARA1642	Aluminum Clear Anodized
SRA1642	Stainless Steel Satin Finish
SRA1640-H12	Extended Head

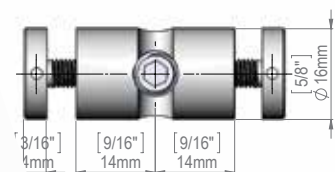

Panel Grips for 1/4" Rod Support

EDGE PIVOTING SUPPORT Support Single Sided

Panel thickness: minimum 1/8" (3 mm),
maximum 1/4" (6.35 mm)

For rod diameter: 1/4" (6 mm)

Ideal for supporting shaped panels such as
circles and ovals

ARA1631	Aluminum Clear Anodized
SRA1631	Stainless Steel Satin Finish

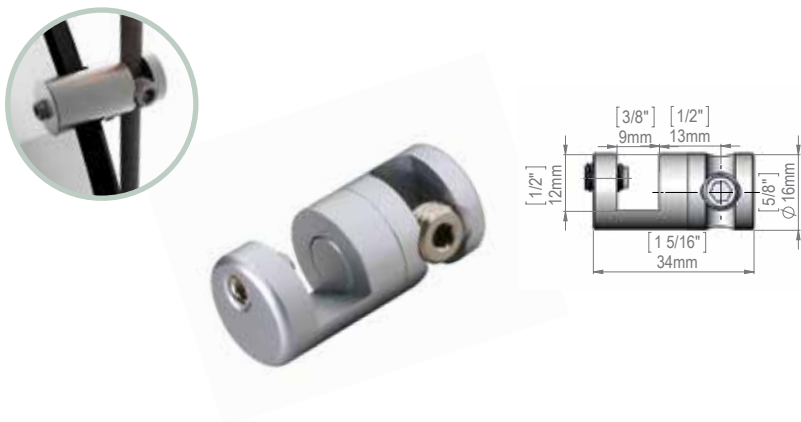

EDGE PIVOTING SUPPORT Support Double Sided

Panel thickness: minimum 1/8" (3 mm),
maximum 1/4" (6.35 mm)

For rod diameter: 1/4" (6 mm)

Ideal for supporting shaped panels such as
circles and ovals

ARA1632	Aluminum Clear Anodized
SRA1632	Stainless Steel Satin Finish

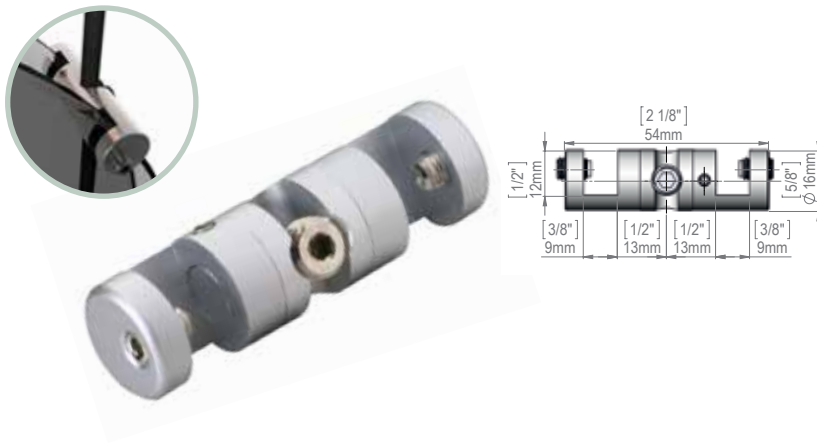

Shelf Supports for 1/4" Rod Support

HORIZONTAL SHELF SUPPORT

Shelf thickness: minimum 1/8" (3 mm)
 Panel drill hole: 1/4" (5.5 mm)
 For rod diameter: 1/4" (6 mm)

ARA1650	Aluminum Clear Anodized
SRA1650	Stainless Steel Satin Finish

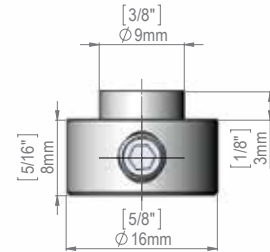

HORIZONTAL SHELF SUPPORT Single Sided

Panel thickness: minimum 1/8" (3 mm),
 maximum 1/4" (6.35 mm)
 Rod spacing: panel width plus 9/16"
 (14 mm)
 For rod diameter: 1/4" (6 mm)

ARB1610	Aluminum Clear Anodized
SRB1610	Stainless Steel Satin Finish

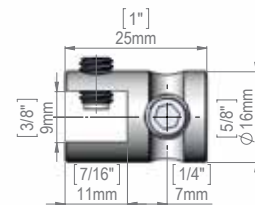

HORIZONTAL SHELF SUPPORT Double Sided

Panel thickness: minimum 1/8" (3 mm),
 maximum 1/4" (6.35 mm)
 Rod spacing: panel width plus 9/16"
 (14 mm)
 For rod diameter: 1/4" (6 mm)

ARB1612	Aluminum Clear Anodized
SRB1612	Stainless Steel Satin Finish

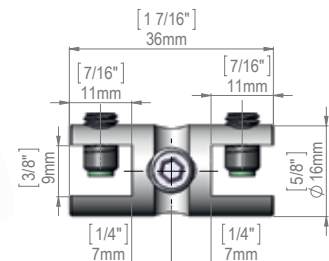

Shelf Supports for 1/4" Rod Support

SHELF PIVOTING SUPPORT

Single Sided

Shelf thickness: minimum 1/4" (6.35 mm),
maximum 3/4" (19 mm)

Rod spacing: panel width plus 1/16"
(14 mm)

For rod diameter: 1/4" (6 mm)

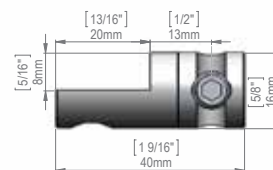

ARA1651	Aluminum Clear Anodized
SRA1651	Stainless Steel Satin Finish

SHELF PIVOTING SUPPORT

Double Sided

Shelf thickness: minimum 1/4" (6.35 mm),
maximum 3/4" (19 mm)

Rod spacing: panel width plus 1/16"
(14 mm)

For rod diameter: 1/4" (6 mm)

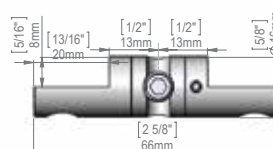

ARA1652	Aluminum Clear Anodized
SRA1652	Stainless Steel Satin Finish

RETAINER SCREW

For Pivoting Support

Shelf thickness: minimum 1/4" (6.50 mm),
maximum 3/8" (9 mm); or more with another
screw

Panel drill hole: 3/16" (5.5 mm)

For parts: ACA1651, ACA1652, SCA1651,
SCA1652

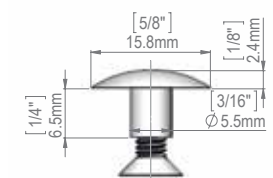

ACA1653	Aluminum Clear Anodized
SCA1653	Stainless Steel Satin Finish

Shelf Supports for 1/4" Rod Support

HORIZONTAL SHELF SUPPORT

Shelf thickness: minimum 1/8" (3 mm)
 Panel drill hole: 1/4" (5.5 mm)
 For rod diameter: 1/4" (6 mm)

ARA1650	Aluminum Clear Anodized
SRA1650	Stainless Steel Satin Finish

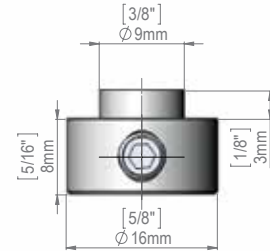

HORIZONTAL SHELF SUPPORT Single Sided

Panel thickness: minimum 1/8" (3 mm),
 maximum 1/4" (6.35 mm)
 Rod spacing: panel width plus 9/16"
 (14 mm)
 For rod diameter: 1/4" (6 mm)

ARB1610	Aluminum Clear Anodized
SRB1610	Stainless Steel Satin Finish

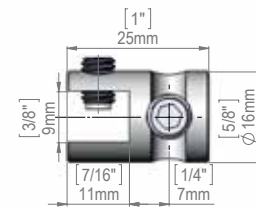

HORIZONTAL SHELF SUPPORT Double Sided

Panel thickness: minimum 1/8" (3 mm),
 maximum 1/4" (6.35 mm)
 Rod spacing: panel width plus 9/16"
 (14 mm)
 For rod diameter: 1/4" (6 mm)

ARB1612	Aluminum Clear Anodized
SRB1612	Stainless Steel Satin Finish

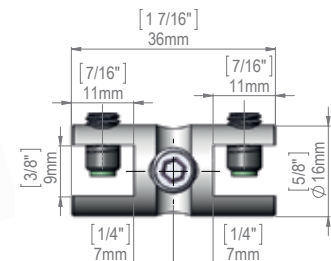

Shelf Supports for 1/4" Rod Support

SHELF PIVOTING SUPPORT

Single Sided

Shelf thickness: minimum 1/4" (6.35 mm),
maximum 3/4" (19 mm)

Rod spacing: panel width plus 1/16"
(14 mm)

For rod diameter: 1/4" (6 mm)

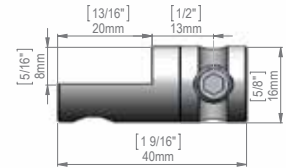

ARA1651	Aluminum Clear Anodized
SRA1651	Stainless Steel Satin Finish

SHELF PIVOTING SUPPORT

Double Sided

Shelf thickness: minimum 1/4" (6.35 mm),
maximum 3/4" (19 mm)

Rod spacing: panel width plus 1/16"
(14 mm)

For rod diameter: 1/4" (6 mm)

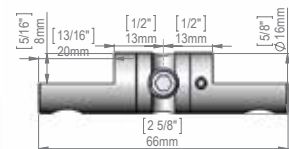

ARA1652	Aluminum Clear Anodized
SRA1652	Stainless Steel Satin Finish

RETAINER SCREW

For Pivoting Support

Shelf thickness: minimum 1/4" (6.50 mm),
maximum 3/8" (9 mm); or more with another
screw

Panel drill hole: 3/16" (5.5 mm)

For parts: ACA1651, ACA1652, SCA1651,
SCA1652

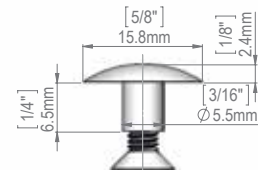

ACA1653	Aluminum Clear Anodized
SCA1653	Stainless Steel Satin Finish

1/4" Rod Accessories



Watch Video

36" ROD

- 1/4" (6 mm) diameter thread and tapped M4
- ROD3 L: 36" (914.40 m) (indoor use only)
- ROD3 can be assembled together to get the length you need, use ROD3-E to close ends
- Can be cut

ROD3	Stainless Steel SS201
ROD3A	Aluminum Clear Anodized



END ROD

Male | Female

1/4" (6 mm) diameter thread and tapped M4

Indoor use only

ROD3-ESS	Stainless Steel SS201
ROD3-EA	Aluminum Clear Anodized

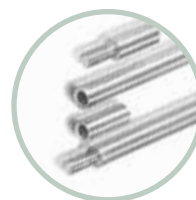

ROD

Stainless steel rod satin finish

1/4" (6 mm) diameter

SRG1900-1 L: 3'3" (1 m)

SRG1900-2 L: 4'11" (1.5 m)

SRG1900-3 L: 6'6" (2 m)

SRG1900-4 L: 8'2" (2.5 m)

SRG1900-1,2,3,4	Stainless Steel SS201
-----------------	-----------------------

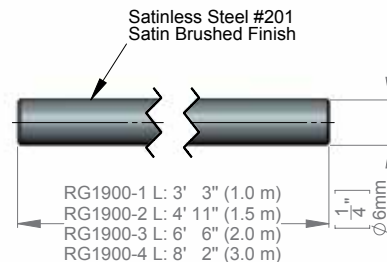

ROD FINISH BALL

Diameter: 1/2" (12.7 mm)

Rod finish ball for rod diameter:

1/4" (6 mm)

ARA1630	Aluminum Clear Anodized
---------	-------------------------

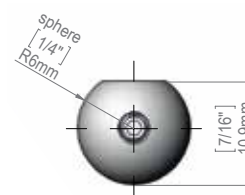

PIVOTING STANDOFF FOR ROD

Diameter: 5/8" (16 mm)

Pivoting standoff ball for rod

diameter: 1/4" (6 mm)

Standoff: 1/2" (12.7 mm)

SSA1724	Stainless Steel SS201
ASA1724	Aluminum Clear Anodized



Aluminum Track and Accessories

ALUMINUM TRACK

Aluminum track fixing for mobility
Clear anodized finished
L: 6' (1.80 m)

AT1911 Aluminum Track

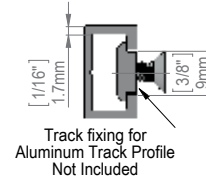

PARALLELOGRAM TRACK FIXING

Parallelogram track fixing for aluminum track profile

ACW4001 Parallelogram Track Fixing

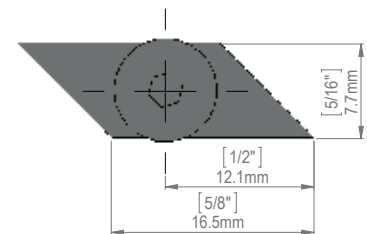

RECTANGLE TRACK FIXING

Rectangle track fixing for aluminum track profile

ACW4002 Rectangle Track Fixing

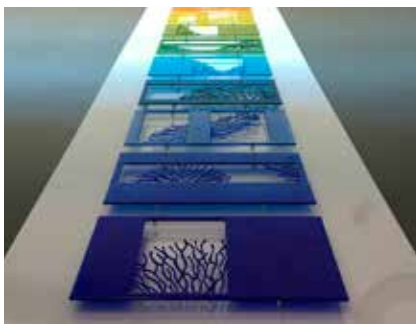
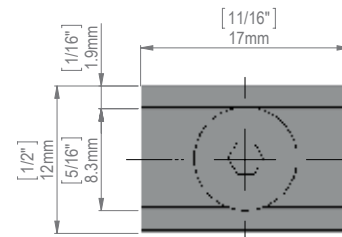



Address: 6420 Benjamin Road
Tampa, FL 33634
Phone: 1-813-938-6025
Fax: 1-813-425-9007
Website: mbs-hanging-systems.com